

# JETTING HEADS AX DIAMOND

## NOZZLES

### Nozzles 296

- Nozzles for jetting element AX 296

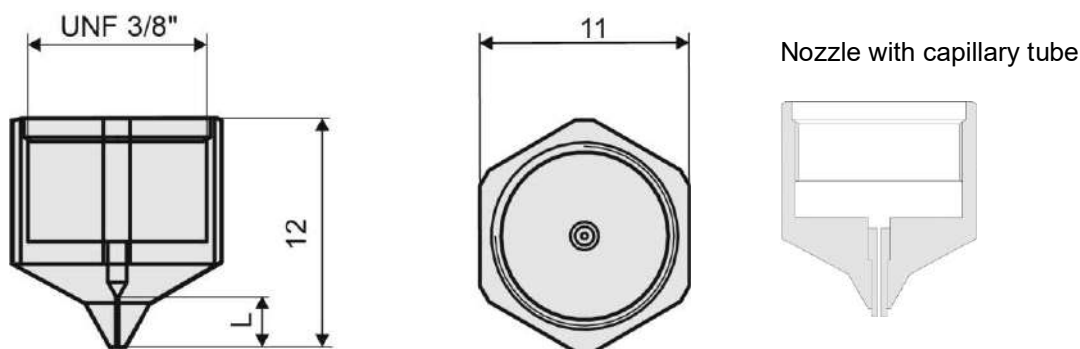

Part no.	Designation	Nozzle Ø	Length L	Material	*Code
122953	Nozzle 296 drilled **	0.20 mm	1.5 mm	Inox	200
122954	Nozzle 296 drilled **	0.20 mm	2.5 mm	Inox	201
100730	Nozzle 296 drilled **	0.25 mm	1.5 mm	Inox	250
102190	Nozzle 296 drilled **	0.25 mm	2.5 mm	Inox	251
100707	Nozzle 296 capillary	0.28 mm	5.0 mm	Brass	28
100731	Nozzle 296 drilled **	0.30 mm	1.5 mm	Inox	300
100357	Nozzle 296 drilled **	0.30 mm	2.5 mm	Inox	301
122956	Nozzle 296 drilled **	0.35 mm	1.5 mm	Inox	350
100358	Nozzle 296 drilled **	0.35 mm	2.5 mm	Inox	351
100735	Nozzle 296 capillary	0.35 mm	5.0 mm	Brass	35
100732	Nozzle 296 drilled	0.40 mm	1.5 mm	Inox	400
100359	Nozzle 296 drilled	0.40 mm	2.5 mm	Inox	401
179410	Nozzle 296 drilled	0.45 mm	1.5 mm	Inox	450
101223	Nozzle 296 drilled	0.50 mm	1.5 mm	Inox	500
100360	Nozzle 296 drilled	0.50 mm	2.5 mm	Inox	501
100737	Nozzle 296 capillary	0.55 mm	5.0 mm	Brass	55
100729	Nozzle 296 drilled	0.60 mm	2.5 mm	Inox	601
100938	Nozzle 296 drilled	0.70 mm	2.5 mm	Inox	701
129294	Nozzle 296 drilled	0.80 mm	2.5 mm	Inox	801
116419	Nozzle 296 drilled	0.90 mm	2.5 mm	Inox	901
119078	Nozzle 296 drilled	1.00 mm	2.5 mm	Inox	1-1
129295	Nozzle 296 drilled	1.20 mm	2.5 mm	Inox	121
129206	Nozzle 296 drilled	1.50 mm	5.0 mm	Inox	151
111240	Nozzle 296 drilled	2.00 mm	5.0 mm	Inox	2-1
104224	Nozzle 296 undrilled	–	2.5 mm	Inox	–
105543	Nozzle 296 undrilled	–	5.5 mm	Inox	–

\*\* Nozzles with precision-drilled holes, ground nozzle tips and individually tested.

# JETTING HEADS AX DIAMOND

## NOZZLES

### Nozzles 294

- Nozzles for jetting element AX 296
- All nozzles are supplied complete with a union nut 117030.

#### Type 1.1

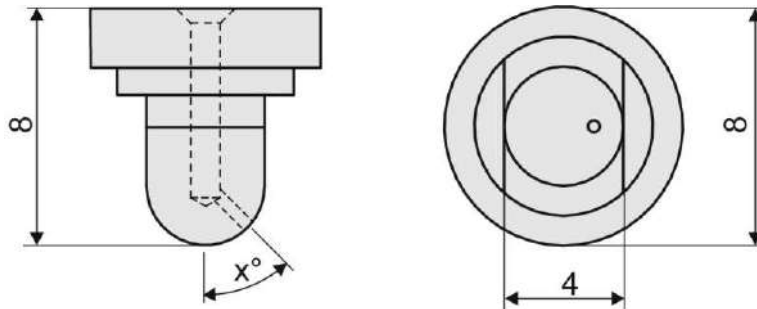

Part no.	Designation	Nozzle Ø	Angle	Type
157161	Nozzle 294 1-hole drilled	0.20 mm	15°	1.1
154190	Nozzle 294 1-hole drilled	0.25 mm	15°	1.1
118149	Nozzle 294 1-hole drilled	0.25 mm	30°	1.1
117603	Nozzle 294 1-hole drilled	0.25 mm	45°	1.1
118117	Nozzle 294 1-hole drilled	0.25 mm	60°	1.1
119341	Nozzle 294 1-hole drilled	0.30 mm	15°	1.1
117207	Nozzle 294 1-hole drilled	0.30 mm	30°	1.1
146675	Nozzle 294 1-hole drilled	0.30 mm	45°	1.1
118296	Nozzle 294 1-hole drilled	0.30 mm	60°	1.1
183155	Nozzle 294 1-hole drilled	0.35 mm	30°	1.1
119342	Nozzle 294 1-hole drilled	0.40 mm	15°	1.1
126614	Nozzle 294 1-hole drilled	0.40 mm	45°	1.1
118297	Nozzle 294 1-hole drilled	0.40 mm	60°	1.1
133891	Nozzle 294 1-hole drilled	0.50 mm	30°	1.1
109343	Nozzle 294 1-hole drilled	0.50 mm	45°	1.1
154603	Nozzle 294 1-hole drilled	0.60 mm	30°	1.1
173841	Nozzle 294 1-hole drilled	0.60 mm	45°	1.1
141444	Nozzle 294 1-hole drilled	0.60 mm	60°	1.1
144757	Nozzle 294 1-hole drilled	0.80 mm	30°	1.1
109342	Nozzle 294 1-hole drilled	0.80 mm	45°	1.1
109341	Nozzle 294 1-hole drilled	1.00 mm	45°	1.1

# JETTING HEADS AX DIAMOND

## NOZZLES

Type 1.2a

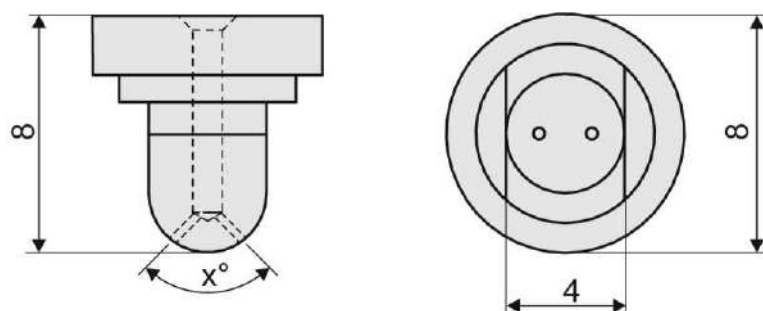

Part no.	Designation	Nozzle Ø	Angle	Type
146264	Nozzle 294 2-hole drilled	0.20 mm	60°	1.2a
170927	Nozzle 294 2-hole drilled	0.20 mm	120°	1.2a
112125	Nozzle 294 2-hole drilled	0.25 mm	30°	1.2a
118584	Nozzle 294 2-hole drilled	0.25 mm	45°	1.2a
119046	Nozzle 294 2-hole drilled	0.25 mm	60°	1.2a
154350	Nozzle 294 2-hole drilled	0.25 mm	120°	1.2a
157094	Nozzle 294 2-hole drilled	0.30 mm	10°	1.2a
100738	Nozzle 294 2-hole drilled	0.30 mm	30°	1.2a
100739	Nozzle 294 2-hole drilled	0.30 mm	45°	1.2a
101224	Nozzle 294 2-hole drilled	0.30 mm	60°	1.2a
101225	Nozzle 294 2-hole drilled	0.30 mm	90°	1.2a
185856	Nozzle 294 2-hole drilled	0.35 mm	5°	1.2a
157096	Nozzle 294 2-hole drilled	0.35 mm	10°	1.2a
179912	Nozzle 294 2-hole drilled	0.35 mm	15°	1.2a
154254	Nozzle 294 2-hole drilled	0.40 mm	5°	1.2a
156079	Nozzle 294 2-hole drilled	0.40 mm	15°	1.2a
178182	Nozzle 294 2-hole drilled	0.40 mm	25°	1.2a
100740	Nozzle 294 2-hole drilled	0.40 mm	30°	1.2a
100741	Nozzle 294 2-hole drilled	0.40 mm	45°	1.2a
101226	Nozzle 294 2-hole drilled	0.40 mm	60°	1.2a
101227	Nozzle 294 2-hole drilled	0.40 mm	90°	1.2a
183146	Nozzle 294 2-hole drilled	0.45 mm	10°	1.2a
101228	Nozzle 294 2-hole drilled	0.50 mm	30°	1.2a
101229	Nozzle 294 2-hole drilled	0.50 mm	45°	1.2a
181414	Nozzle 294 2-hole drilled	0.50 mm	50°	1.2a
101230	Nozzle 294 2-hole drilled	0.50 mm	60°	1.2a
101231	Nozzle 294 2-hole drilled	0.50 mm	90°	1.2a
153031	Nozzle 294 2-hole drilled	0.50 mm	120°	1.2a
180167	Nozzle 294 2-hole drilled	0.50 mm	180°	1.2a
177857	Nozzle 294 2-hole drilled	0.60 mm	10°	1.2a
153732	Nozzle 294 2-hole drilled	0.60 mm	15°	1.2a
178262	Nozzle 294 2-hole drilled	0.60 mm	20°	1.2a
118648	Nozzle 294 2-hole drilled	0.60 mm	30°	1.2a
119171	Nozzle 294 2-hole drilled	0.60 mm	35°	1.2a
154461	Nozzle 294 2-hole drilled	0.60 mm	45°	1.2a
180161	Nozzle 294 2-hole drilled	0.60 mm	90°	1.2a
155006	Nozzle 294 2-hole drilled	0.60 mm	120°	1.2a

# JETTING HEADS AX DIAMOND

## NOZZLES

180165	Nozzle 294 2-hole drilled	0.60 mm	160°	1.2a
118649	Nozzle 294 2-hole drilled	0.70 mm	30°	1.2a
118807	Nozzle 294 2-hole drilled	0.70 mm	45°	1.2a
156446	Nozzle 294 2-hole drilled	0.70 mm	90°	1.2a
175484	Nozzle 294 2-hole drilled	0.80 mm	15°	1.2a
117853	Nozzle 294 2-hole drilled	0.80 mm	30°	1.2a
146928	Nozzle 294 2-hole drilled	0.80 mm	90°	1.2a
174022	Nozzle 294 2-hole drilled	0.90 mm	15°	1.2a
175216	Nozzle 294 2-hole drilled	0.90 mm	90°	1.2a
172933	Nozzle 294 2-hole drilled	1.00 mm	30°	1.2a

**Type 1.2b**

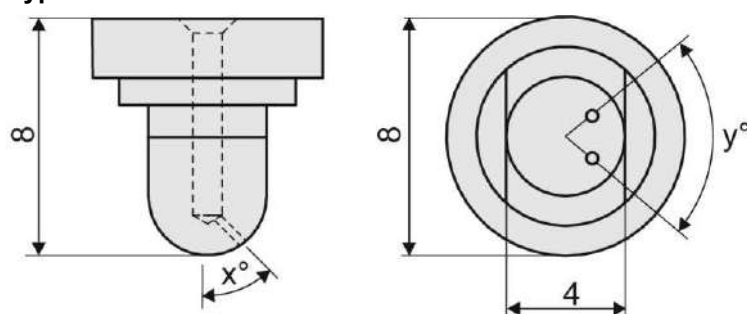

Part no.	Designation	Nozzle Ø	Angle	Type
123497	Nozzle 294 2-hole drilled	0.25 mm	60° / 90°	1.2b
126617	Nozzle 294 2-hole drilled	0.40 mm	62.5° / 115°	1.2b
126618	Nozzle 294 2-hole drilled	0.50 mm	52° / 120°	1.2b

**Type 1.2c**

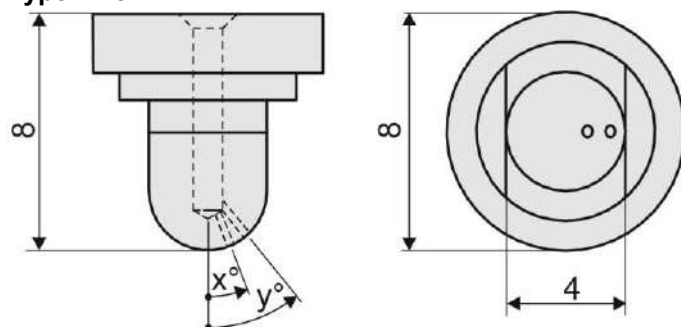

Part no.	Designation	Nozzle Ø	Angle	Type
126409	Nozzle 294 2-hole drilled	0.30 mm	30° / 60°	1.2c
128249	Nozzle 294 2-hole drilled	0.30 mm	0° / 45°	1.2c
129119	Nozzle 294 2-hole drilled	0.30 / 0.35 mm	10° / 45°	1.2c
129478	Nozzle 294 2-hole drilled	0.30 / 0.35 mm	10° / 30°	1.2c
131696	Nozzle 294 2-hole drilled	0.30 / 0.35 mm	0° / 25°	1.2c
135115	Nozzle 294 2-hole drilled	0.40 / 0.45 mm	0° / 25°	1.2c
121984	Nozzle 294 2-hole drilled	0.70 mm	0° / 90°	1.2c
180080	Nozzle 294 2-hole drilled	0.70 mm	0° / 45°	1.2c

# JETTING HEADS AX DIAMOND

## NOZZLES

**Type 1.3**

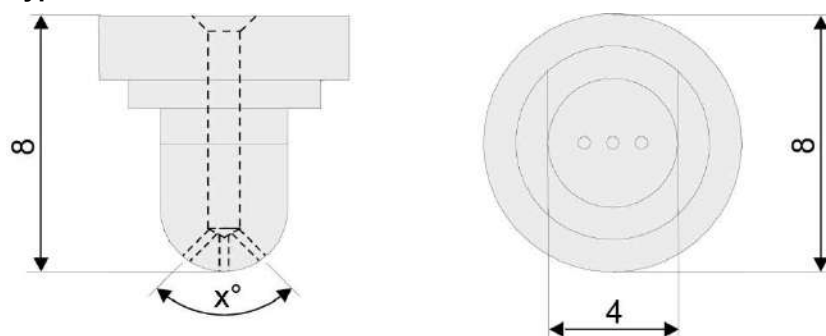

Part no.	Designation	Nozzle Ø	Angle	Type
112197	Nozzle 294 3-hole drilled	0.25 mm	45°	1.3
111693	Nozzle 294 3-hole drilled	0.25 mm	90°	1.3
115084	Nozzle 294 3-hole drilled	0.30 mm	45°	1.3
110926	Nozzle 294 3-hole drilled	0.30 mm	60°	1.3
117645	Nozzle 294 3-hole drilled	0.30 mm	90°	1.3
179804	Nozzle 294 3-hole drilled	0.40 mm	30°	1.3
115083	Nozzle 294 3-hole drilled	0.40 mm	45°	1.3
116353	Nozzle 294 3-hole drilled	0.40 mm	60°	1.3
136294	Nozzle 294 3-hole drilled	0.50 mm	60°	1.3
136295	Nozzle 294 3-hole drilled	0.60 mm	60°	1.3
137279	Nozzle 294 3-hole drilled	0.70 mm	60°	1.3

**Type 1.4a**

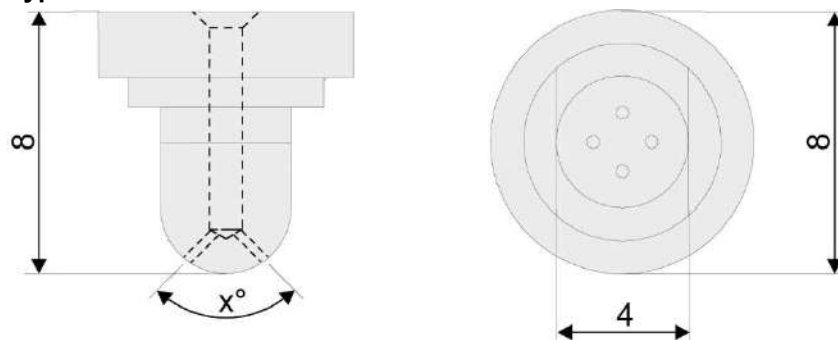

Part no.	Designation	Nozzle Ø	Angle	Type
101232	Nozzle 294 4-hole drilled	0.30 mm	2 × 60°	1.4a
101588	Nozzle 294 4-hole drilled	0.30 mm	2 × 70°	1.4a
101233	Nozzle 294 4-hole drilled	0.30 mm	2 × 90°	1.4a
160007	Nozzle 294 4-hole drilled	0.35 mm	2 × 45°	1.4a
146056	Nozzle 294 4-hole drilled	0.40 mm	2 × 45°	1.4a
175482	Nozzle 294 4-hole drilled	0.40 mm	2 × 50°	1.4a
114161	Nozzle 294 4-hole drilled	0.50 mm	2 × 90°	1.4a

# JETTING HEADS AX DIAMOND

## NOZZLES

**Type 1.4b**

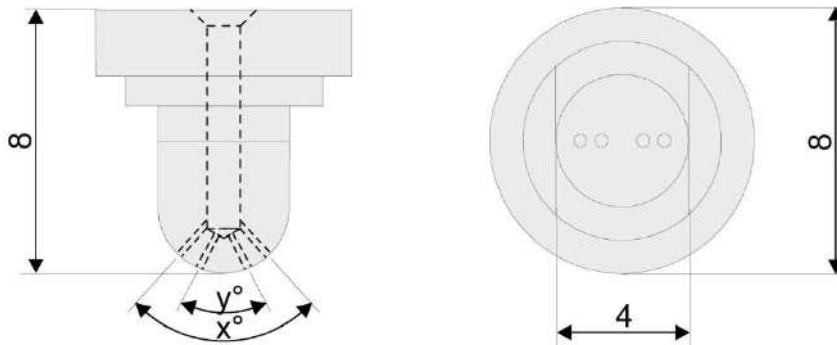

Part no.	Designation	Nozzle Ø	Angle	Type
103520	Nozzle 294 4-hole drilled	0.30 mm	60° / 30°	1.4b
127909	Nozzle 294 4-hole drilled	0.30 mm	76° / 35°	1.4b
103521	Nozzle 294 4-hole drilled	0.30 mm	90° / 45°	1.4b
141994	Nozzle 294 4-hole drilled	0.35 mm	80° / 50°	1.4b
127908	Nozzle 294 4-hole drilled	0.40 mm	76° / 35°	1.4b
122814	Nozzle 294 4-hole drilled	0.50 mm	76° / 35°	1.4b

**Type 1.6**

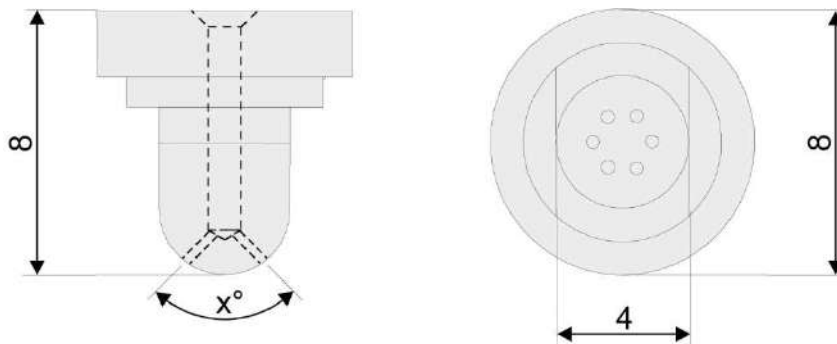

Part no.	Designation	Nozzle Ø	Angle	Type
123147	Nozzle 294 6-hole drilled	0.25 mm	160°	1.6
179444	Nozzle 294 6-hole drilled	0.25 mm	70°	1.6
126635	Nozzle 294 6-hole drilled	0.30 mm	170°	1.6
126630	Nozzle 294 6-hole drilled	0.30 mm	90°	1.6
178224	Nozzle 294 6-hole drilled	0.30 mm	60°	1.6
179802	Nozzle 294 6-hole drilled	0.30 mm	45°	1.6
179800	Nozzle 294 6-hole drilled	0.30 mm	30°	1.6
162299	Nozzle 294 6-hole drilled	0.40 mm	120°	1.6
162297	Nozzle 294 6-hole drilled	0.40 mm	90°	1.6
167208	Nozzle 294 6-hole drilled	0.40 mm	60°	1.6

# JETTING HEADS AX DIAMOND

## NOZZLES

### Type 2.2b

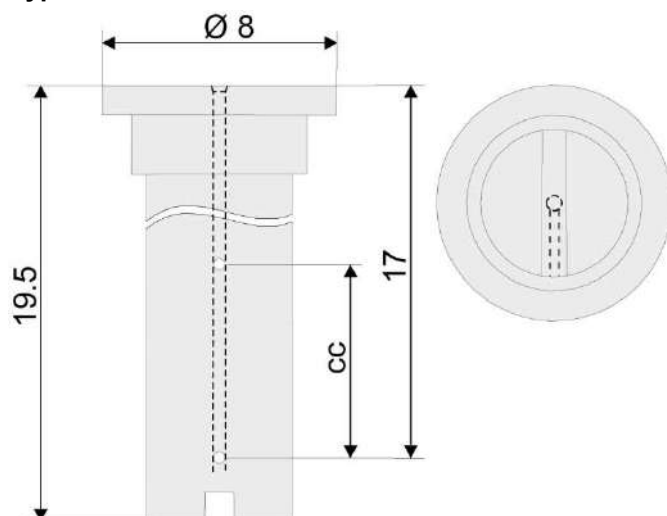

Part no.	Designation	Nozzle Ø	Angle	Type
126343	Nozzle 294 2-hole drilled	0.50 mm	cc 7 mm	2.2b
138237	Nozzle 294 2-hole drilled	0.50/0.70 mm	cc 5 mm	2.2b

### Type 3.1

Fitted with union nut 130776.

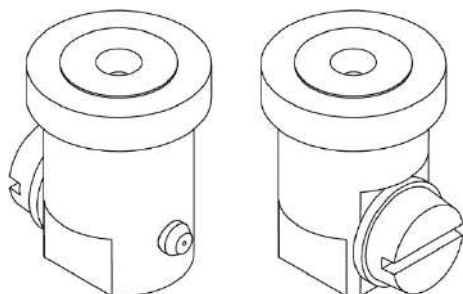

Part no.	Designation	Nozzle Ø	Angle	Type
130902	Nozzle 294 1-hole drilled	0.20 mm	–	3.1
154045	Nozzle 294 1-hole drilled	0.25 mm	–	3.1
130775	Nozzle 294 1-hole drilled	0.30 mm	–	3.1
154046	Nozzle 294 1-hole drilled	0.35 mm	–	3.1
130896	Nozzle 294 1-hole drilled	0.40 mm	–	3.1
130897	Nozzle 294 1-hole drilled	0.50 mm	–	3.1
130898	Nozzle 294 1-hole drilled	0.60 mm	–	3.1
148011	Nozzle 294 1-hole drilled	0.70 mm	–	3.1
149023	Nozzle 294 1-hole drilled	0.80 mm	–	3.1
149025	Nozzle 294 1-hole drilled	1.00 mm	–	3.1

# JETTING HEADS AX DIAMOND

## NOZZLES

### Type 3.2

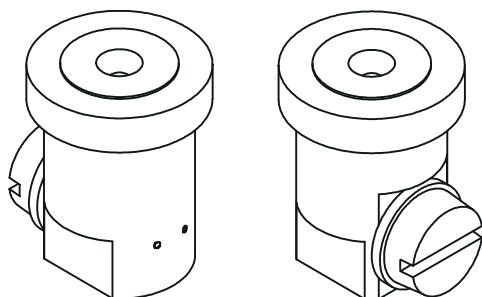

Part no.	Designation	Nozzle Ø	Angle	Type
175164	Nozzle 294 2-hole drilled	0.20 mm	120°	3.2
143754	Nozzle 294 2-hole drilled	0.25 mm	60°	3.2
143755	Nozzle 294 2-hole drilled	0.30 mm	30°	3.2
143756	Nozzle 294 2-hole drilled	0.30 mm	45°	3.2
143757	Nozzle 294 2-hole drilled	0.30 mm	60°	3.2
143758	Nozzle 294 2-hole drilled	0.30 mm	90°	3.2
153837	Nozzle 294 2-hole drilled	0.35 mm	15°	3.2
163742	Nozzle 294 2-hole drilled	0.40 mm	10°	3.2
152527	Nozzle 294 2-hole drilled	0.40 mm	15°	3.2
143759	Nozzle 294 2-hole drilled	0.40 mm	20°	3.2
143760	Nozzle 294 2-hole drilled	0.40 mm	30°	3.2
143761	Nozzle 294 2-hole drilled	0.40 mm	45°	3.2
143762	Nozzle 294 2-hole drilled	0.40 mm	60°	3.2
143763	Nozzle 294 2-hole drilled	0.40 mm	90°	3.2
143764	Nozzle 294 2-hole drilled	0.40 mm	180°	3.2
168109	Nozzle 294 2-hole drilled	0.45 mm	15°	3.2
154409	Nozzle 294 2-hole drilled	0.50 mm	10°	3.2
143765	Nozzle 294 2-hole drilled	0.50 mm	15°	3.2
143766	Nozzle 294 2-hole drilled	0.50 mm	30°	3.2
143767	Nozzle 294 2-hole drilled	0.50 mm	45°	3.2
143768	Nozzle 294 2-hole drilled	0.50 mm	60°	3.2
143769	Nozzle 294 2-hole drilled	0.50 mm	90°	3.2
143770	Nozzle 294 2-hole drilled	0.60 mm	15°	3.2
143771	Nozzle 294 2-hole drilled	0.60 mm	30°	3.2
143772	Nozzle 294 2-hole drilled	0.70 mm	30°	3.2
143773	Nozzle 294 2-hole drilled	0.70 mm	45°	3.2
143774	Nozzle 294 2-hole drilled	0.80 mm	30°	3.2



# JETTING HEADS AX DIAMOND

## NOZZLES

### Type 3.2b

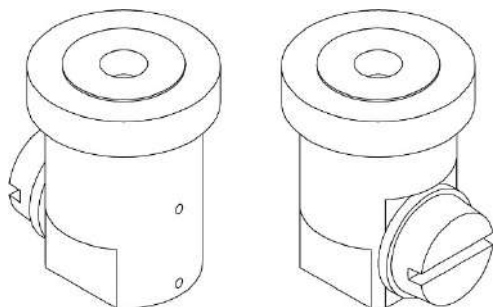

Part no.	Designation	Nozzle Ø	Angle	Type
147672	Nozzle 294 2-hole drilled	0.40 mm	60°	3.2b
147288	Nozzle 294 2-hole drilled	0.40 mm	0 /15°	3.2b
148046	Nozzle 294 2-hole drilled	0.40 mm	0 /60°	3.2

### Coating application

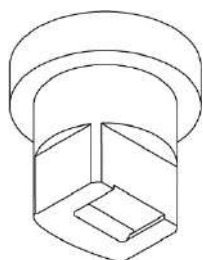

Part no.	Designation	Nozzle Ø	Application width	Type
167909	Nozzle 294 coating application	0.2 mm	1.5.0x0.2 mm	Coating application
137862	Nozzle 294 coating application	0.2 mm	2.0x0.2 mm	Coating application
127402	Nozzle 294 coating application	0.3 mm	3.0x0.2 mm	Coating application
167911	Nozzle 294 coating application	0.3 mm	4.0x0.2 mm	Coating application
176582	Nozzle 294 coating application	0.3 mm	4.0x0.4 mm	Coating application

All nozzles are supplied complete with a union nut 117030.

Part no.	Designation	Material
117030	Union nut for nozzle 294 for fitting nozzles on type 296 valve heads	Inox

**Exception: Nozzles of type 3.1 are fitted with a union nut 130776.**

*Spare parts for union nut type 3.1:*

Part no.	Designation
130776	Union nut for nozzle 294/3.1 UNF 3/8"
140512	Cylinder screw M2.5 × 2.5
140320	Washer M2.5

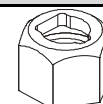

# JETTING HEADS AX DIAMOND

## NOZZLES

### Sift-proof nozzles

- Nozzles for jetting element AX 296
- All sift-proof nozzles are supplied complete with a union nut 117030.

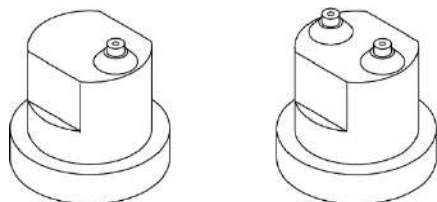

Part no.	Designation	Nozzle Ø	Distance	Capillary tube
133689	Nozzle 1-hole sift-proof	0.25 mm	cc 3.66 mm	L 2.50 mm
131151	Nozzle 1-hole sift-proof	0.30 mm	cc 3.66 mm	L 2.50 mm
144108	Nozzle 1-hole sift-proof	0.35 mm	cc 4.50 mm	L 2.50 mm
133690	Nozzle 2-hole sift-proof	0.25 mm	cc 3.66 mm	L 1.50 mm
157088	Nozzle 2-hole sift-proof	0.25 mm	cc 4.50 mm	L 1.50 mm
130420	Nozzle 2-hole sift-proof	0.30 mm	cc 3.66 mm	L 1.50 mm
147196	Nozzle 2-hole sift-proof	0.35 mm	cc 3.66 mm	L 1.50 mm
139691	2-hole, sift-proof nozzle, spec.	0.25 mm / 30°	cc 3.66 mm	L 2.50 mm
142357	Nozzle 2-hole sift-proof	0.30 mm	cc 4.50 mm	L 1.50 mm
142315	Nozzle 2-hole sift-proof	0.35 mm	cc 4.50 mm	L 1.50 mm
149985	Nozzle 2-hole sift-proof	0.40 mm	cc 4.50 mm	L 1.50 mm
150887	Nozzle 2-hole sift-proof	0.50 mm	cc 3.66 mm	L 1.50 mm
150646	Nozzle 2-hole sift-proof	0.50 mm	cc 4.50 mm	L 1.50 mm
150888	Nozzle 2-hole sift-proof	0.60 mm	cc 3.66 mm	L 1.50 mm
150648	Nozzle 2-hole sift-proof	0.60 mm	cc 4.50 mm	L 1.50 mm
148664	Nozzle 2-hole sift-proof	0.70 mm	cc 4.50 mm	L 1.50 mm